

NOTES

02	05.10.17	REVISED AS PER CEC COMMENTS	ED	NH	NH
01	27.09.17	ISSUED FOR APPROVAL	ED	GR	NH
Rev.	Date	Amendment Details	Drw'n	Chk'd	App'd

This drawing should not be relied on or used in circumstances other than those for which it was originally prepared and for which Sweco UK Limited was commissioned. Sweco UK Limited accepts no responsibility for this drawing to any party other than the person by whom it was commissioned. Any party which breaches the provisions of this disclaimer shall indemnify Sweco UK Limited for all loss or damage arising therefrom.

Sweco
Spectrum House
2 Powderhall Road
Edinburgh
EH7 4GB
Tel: +44 (0)131 550 6300
Web: www.sweco.co.uk

SWECO

Client

Drawing Status

APPROVAL ISSUE

Project Title

EDINBURGH
ST JAMES
PUTTING EDINBURGH FIRST

Drawing Title

LEITH STREET
PROPOSED TRAFFIC
REGULATION ORDERS
SHEET 1 OF 3

Scale	1:500	Designed	ED	Drawn	ED	Checked	GR	Approved	NH	
Original Size	A3	Date	27.09.17	Date	27.09.17	Date	27.09.17	Date	27.09.17	
Drawing Number	ESJ-SWE-Z1-XXX-DR-TR-02301								Revision	02

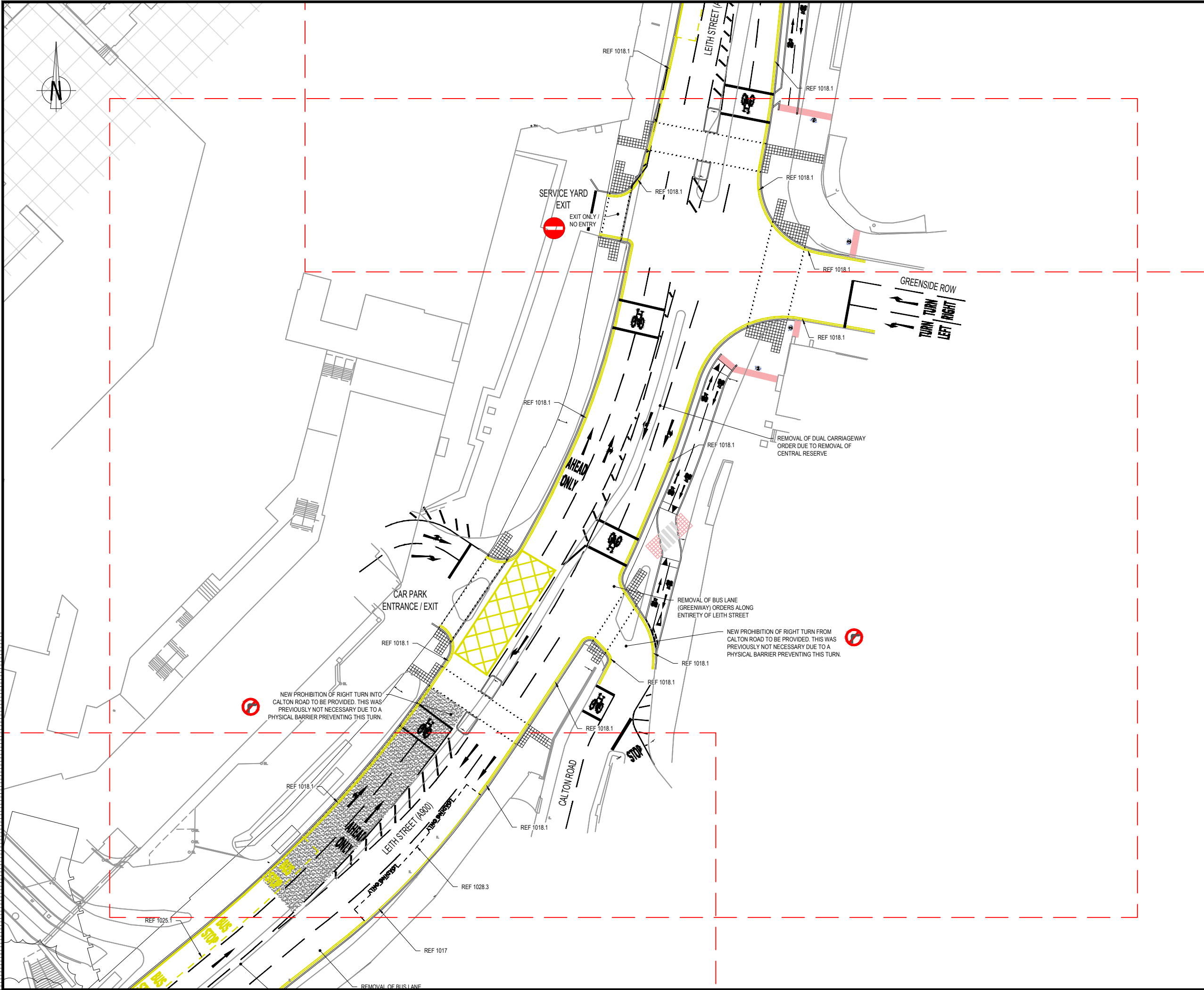

NOTES

02	05.10.17	REVISED AS PER CEC COMMENTS	ED	NH	NH
01	27.09.17	ISSUED FOR APPROVAL	ED	GR	NH
Rev.	Date	Amendment Details	Drw'n	Chk'd	App'd

This drawing should not be relied on or used in circumstances other than those for which it was originally prepared and for which Sweco UK Limited was commissioned. Sweco UK Limited accepts no responsibility for this drawing to any party other than the person by whom it was commissioned. Any party which breaches the provisions of this disclaimer shall indemnify Sweco UK Limited for all loss or damage arising therefrom.

Sweco
Spectrum House
2 Powderhall Road
Edinburgh
EH7 4GB
Tel: +44 (0)131 550 6300
Web: www.sweco.co.uk



Client



Drawing Status

APPROVAL ISSUE

Project Title

EDINBURGH
ST JAMES
PUTTING EDINBURGH FIRST

Drawing Title

LEITH STREET
PROPOSED TRAFFIC
REGULATION ORDERS
SHEET 2 OF 3

Scale	1:500	Designed	ED	Drawn	ED	Checked	GR	Approved	NH
Original Size	A3	Date	27.09.17	Date	27.09.17	Date	27.09.17	Date	27.09.17
Drawing Number	ESJ-SWE-Z1-XXX-DR-TR-02302								Revision

02

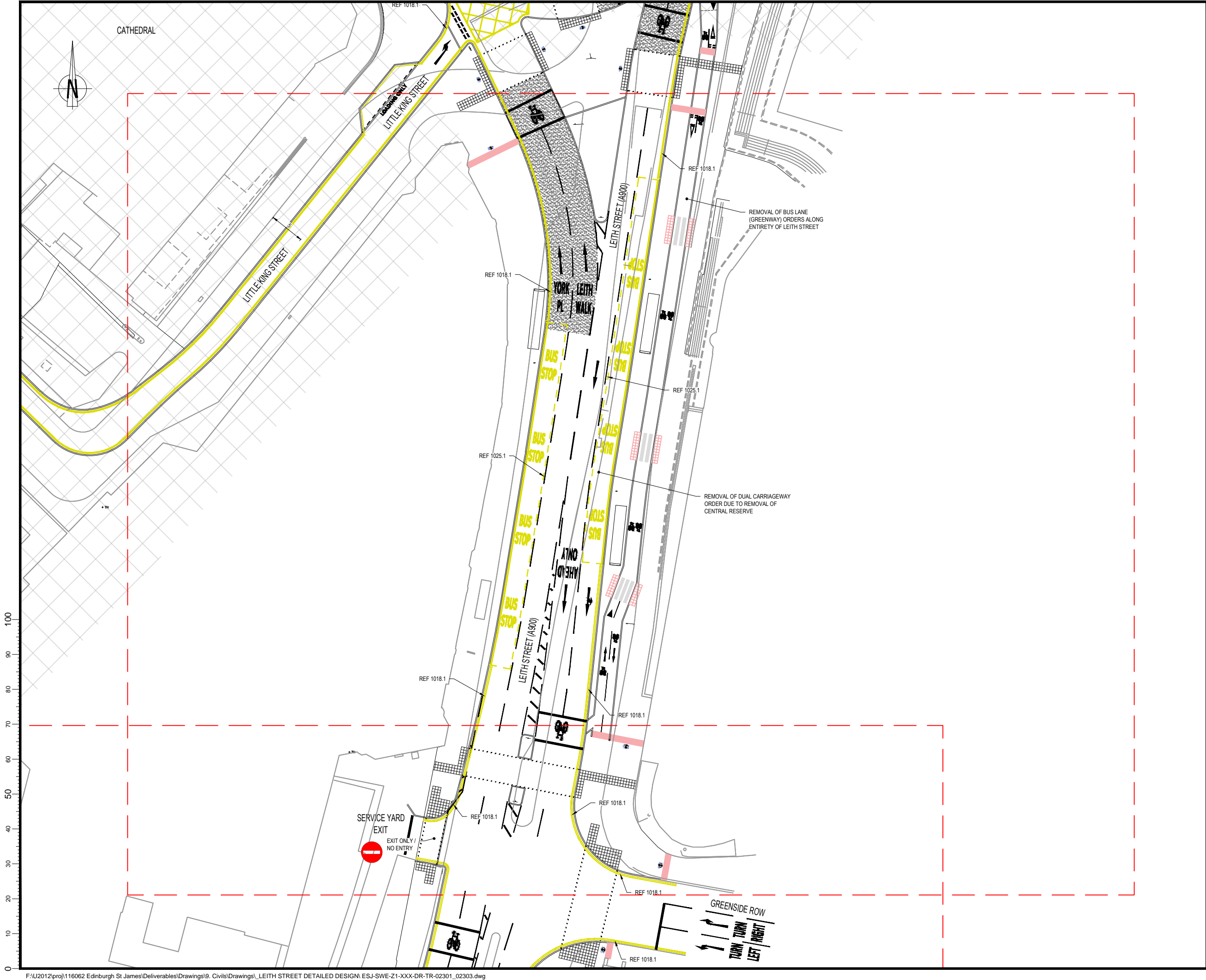

NOTES

1. NOTES

02	05.10.17	REVISED AS PER CEC COMMENTS	ED	NH	NH
01	27.09.17	ISSUED FOR APPROVAL	ED	GR	NH
Rev.	Date	Amendment Details	Drw'n	Chk'd	App'd

This drawing should not be relied on or used in circumstances other than those for which it was originally prepared and for which Sweco UK Limited was commissioned. Sweco UK Limited accepts no responsibility for this drawing to any party other than the person by whom it was commissioned. Any party which breaches the provisions of this disclaimer shall indemnify Sweco UK Limited for all loss or damage arising therefrom.

Sweco
Spectrum House
2 Powderhall Road
Edinburgh
EH7 4GB
Tel: +44 (0)131 550 6300
Web: www.sweco.co.uk

SWECO

Client

Drawing Status

APPROVAL ISSUE

Project Title

EDINBURGH
ST JAMES
PUTTING EDINBURGH FIRST

Drawing Title

LEITH STREET
PROPOSED TRAFFIC
REGULATION ORDERS
SHEET 3 OF 3

Scale	1:500	Designed	ED	Drawn	ED	Checked	GR	Approved	NH	
Original Size	A3	Date	27.09.17	Date	27.09.17	Date	27.09.17	Date	27.09.17	
Drawing Number	ESJ-SWE-Z1-XXX-DR-TR-02303								Revision	02

F:\U2012\proj\116062 Edinburgh St James\Deliverables\Drawings\9. Civils\Drawings\LEITH STREET DETAILED DESIGN\ESJ-SWE-Z1-XXX-DR-TR-02301_02303.dwg